

***Note:**
8 x 10 booths are highlighted in green below.
 Booths that are not highlighted are 10 x 10 booths.

INTERACTIVE CONVENTION - 2024

07/15/24 - 07/17/24

JW MARRIOTT - GRIFFIN HALL - AUSTIN, TX

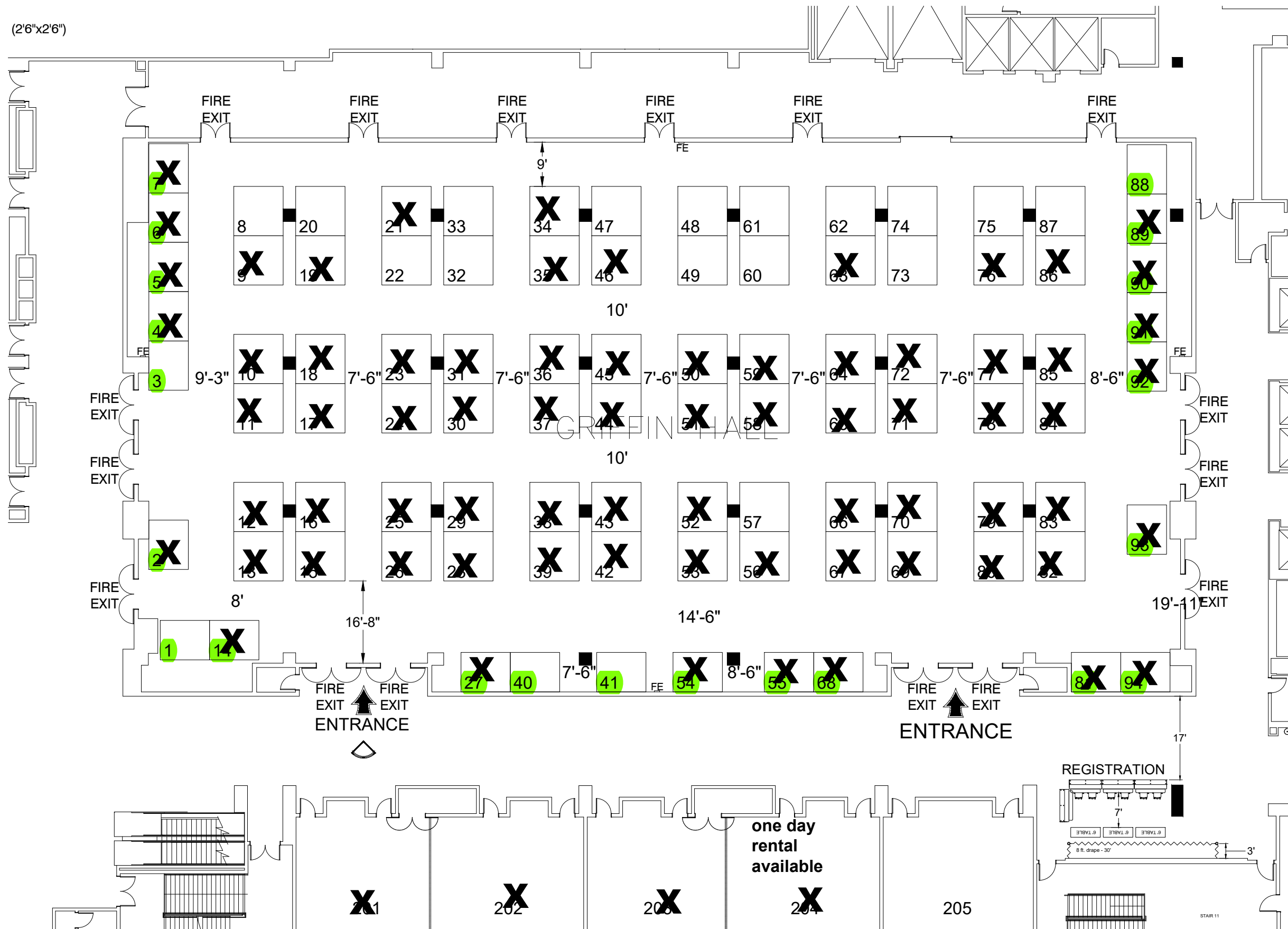

REVISION

Date: 3/25/2024
 By: Jo Ann Shimek

BOOTH COUNT

Inventory as of 03/25/2024

Count	Size	Qty	Sq Ft	Remain	Available
100%	8'x10'	80	2,200	0	22
100%	10'x10'	100	7,200	0	72
	Total:	184	9,400	0	94

BLDG. LEGEND:

DRAWING INFO

Passport Line Item Number:
#12360577
 Facility:
 JW MARRIOTT
 Facility Location:
 GRIFFIN HALL
 City & State:
 AUSTIN, TX
 Scale: CUSTOM
 Project #: 528623
 Acct. Sales: ---
 Acct. Mgmt.: CRYSTAL ELLIOTT
 Started: 3/8/2024
 Started By: JO ANN SHIMEK
 Prod. Branch: SAN ANTONIO



Disclaimer - This floor plan is preliminary and subject to change pending review and official approval by all authorities having jurisdiction. Every effort has been made to ensure the accuracy of all information contained on this floor plan. However, no warranties, either expressed or implied, are made with respect to this floor plan. If the location of building columns, utilities or other architectural components of the facility is a consideration in the construction or usage of an exhibit, it is the sole responsibility of the exhibitor to physically inspect the facility to verify all dimension and locations.
 © Copyright 2024, Freeman Co. All rights reserved.

Confidential and Proprietary - the information contained herein is the proprietary information of Freeman and by accessing the information, the recipient agrees to keep the information confidential and not disclose it to any third party without the prior consent of Freeman. Recipient also agrees to only use the information for its internal evaluation purposes and for no other purpose, without the prior consent of Freeman.

File Path: C:\Vault\Designs\Projects\Interactive Conventions\IC2407\Event\Floor Plans\ICE24.dwg | Tab Name: L12360577 FP